

# Quick Ship Program

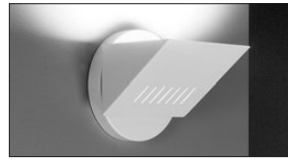

catalog no. Q - 150 - 77 - 1 - WH  
 vector | model 150  
 • 150 watt max. quartz halogen (dc bayonet)  
 • white finish

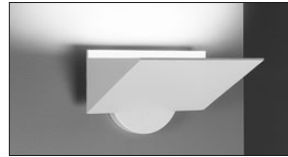
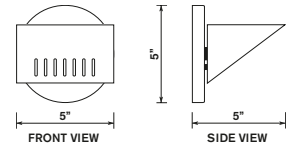

catalog no. Q - 154 - 71 - 1 - WH  
 folio | model 154  
 • 300 watt max. quartz halogen (t-3 double ended) - included  
 • white finish

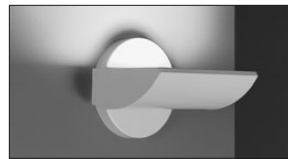
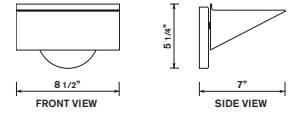

catalog no. Q - 161 - 77 - 1 - WH  
 patina | model 161  
 • 150 watt max. quartz halogen (dc bayonet)  
 • white finish

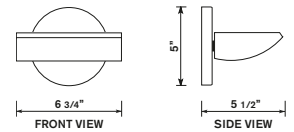

catalog no. Q - 177 - 13 - E - U - WH  
 quadratto | model 177  
 • 13 watt quad tube (G24q-1)  
 • white finish  
 • electronic ballast

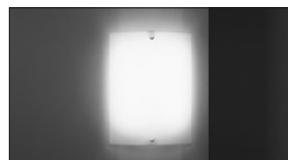
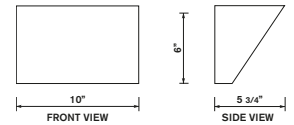

catalog no. Q - 182 - 2/18 - E - U - WH  
 centrum | model 182 **ADA**  
 • two - 18 watt twin tubes (2G11)  
 • frosted white acrylic w/polished brass knobs  
 • electronic ballast

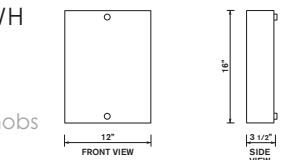

catalog no. Q - 189 - 2/27 - E - U - WA  
 tandem | model 189 **ADA**  
 • two - 27 watt twin tubes (2G11)  
 • frosted white acrylic w/chrome trim  
 • electronic ballast

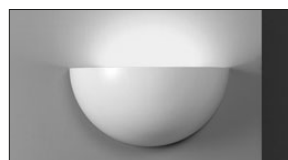
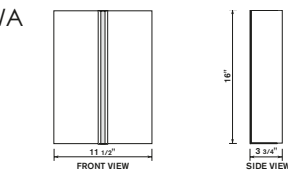

catalog no. Q - 312 - 26 - E - U - WH  
 merida | model 312  
 • 26 watt quad tube (G24q-3)  
 • white finish  
 • electronic ballast

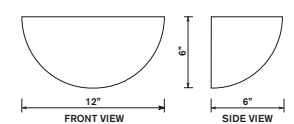

catalog no. Q - 340 - 26 - E - U - AL - PB  
 myka | model 340 **ADA**  
 • 26 watt quad tube (G24q-3)  
 • white finish  
 • electronic ballast

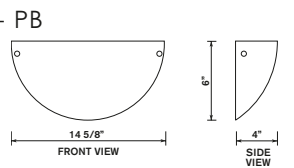

catalog no. Q - 362 - 2/13 - E - U - WH - WA  
 monterra | model 362 **ADA**  
 • two - 13 watt twin tubes (2Gx7)  
 • frosted white acrylic  
 • electronic ballast

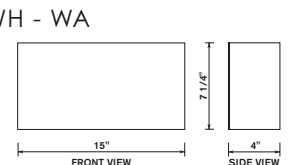

# Quick Ship Program



catalog no. Q - MX - 13 - FM - U - E - 48

mx 13 | flexible module

- 13 watt twin tube (2Gx7)
- 48 inches (6 lamps)
- electronic ballast

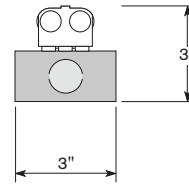
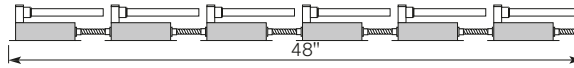

catalog no. Q - MX - 40 - FM - U - E - 48

mx 40 | flexible module

- 40 watt twin tube (4 pin - 2G11)
- 48 inches (2 lamps)
- electronic ballast

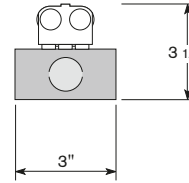
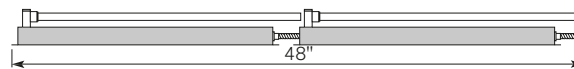

## QUICK SHIP TERMS & CONDITIONS

**Quick Ship "Q" Designation** | To ensure accurate order processing, please add the prefix Q to the model on the purchase order. Example: Q-177-13-E-U-WH

**Lamps** | Lamps are not included with fixtures except as noted on Model Q-154 which does include lamping.

**Quantity Limitations** | The Quick Ship program is designed to rapidly fill orders of up to twenty (20) Quick Ship Program models. Please contact your Electrix representative or the factory for larger order quantities.

**Modifications** | In order to fulfill the intent of the Quick Ship program, please limit orders to the models and options detailed in this brochure. Please consult the factory for lead-times on modified or other Electrix products.

Design Modification Rights Reserved.

**Changes and Cancellations** | Changes to Quick Ship orders may require a lead-time adjustment and fee. Order cancellations are subject to a nominal restocking charge.

**Next Day Air Shipments** | Orders will ship according to standard freight terms if the factory is not instructed to ship differently. Next day air delivery is available at an additional cost.

**Delivery Commitment** | The Electrix Quick Ship program is designed to fulfill short lead-time project requirements. We are committed to maintaining stock for all models in the Quick Ship program to ensure prompt delivery of time sensitive orders, however, we urge you to consult factory for current inventory levels.