

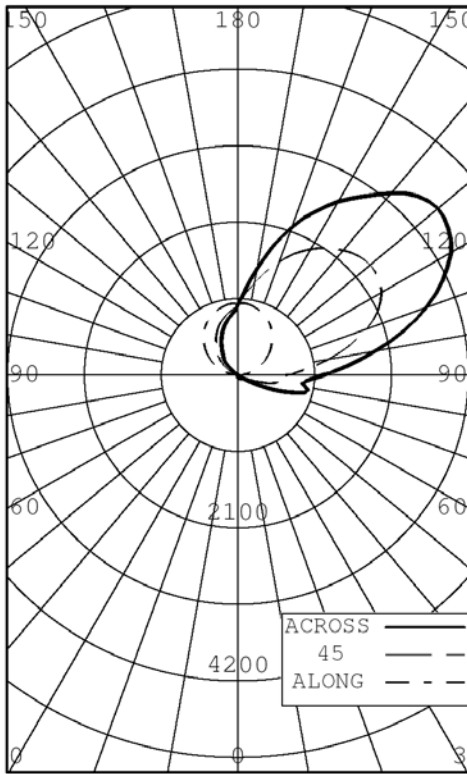

CERTIFIED TEST REPORT No. 27322

ELECTRIX - INDIRECT COVE LUMINAIRE, CAT# FX 54UE52  
WITH SPECULAR HAMMERTONE REFLECTOR AND WHITE PAINTED REFLECTOR  
TWO GE 54 WATT T5 LAMP, CAT# F54W-T5/841/ECO. LUMEN RATING = 4450 LMS.  
ONE LUTRON EC5T554JUNV2 BALLAST OPERATING AT 120 VAC AND 126 WATTS



ANGLE	INTENSITY (CANDLEPOWER) SUMMARY					OUTPUT LUMENS
	ALONG	BEAM SIDE		ACROSS		
0	15	67.5	45	22.5	15	
5	26	23	24	26	24	1
15	28	26	36	41	40	5
25	28	26	35	42	44	8
35	28	27	42	46	51	12
45	25	26	40	50	62	15
55	22	25	34	53	71	21
65	17	62	118	285	401	88
75	12	127	439	758	946	228
85	7	278	533	770	942	291
90	7	322	670	964	1172	
95	45	520	922	1260	1508	478
105	197	1001	1575	2013	2342	769
115	361	1292	2115	2688	3091	963
125	518	1436	2343	3046	3512	986
135	669	1507	2318	3013	3479	858
145	796	1457	2128	2640	2995	639
155	894	1354	1842	2220	2472	412
165	957	1209	1472	1685	1828	207
175	990	1056	1119	1165	1192	56
180	976	976	976	976	976	

BOTH SIDES  
ZONAL LUMENS AND PERCENTAGES

ZONE	LUMENS	% LAMP	% LUMINAIRE
0-30	27	0.30	0.38
0-40	47	0.52	0.67
0-60	95	1.07	1.37
0-90	707	7.95	10.18
40-90	661	7.42	9.51
60-90	612	6.87	8.81
90-180	6237	70.08	89.82
0-180	6945	78.03	100.00

\*\* EFFICIENCY: 78.0% \*\*

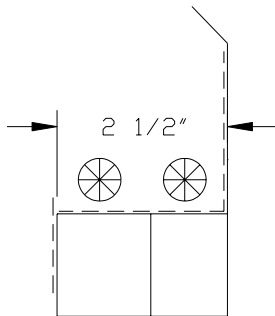

CERTIFIED BY:

*Joseph E. Walker III*

DATE:  
JUL 14, 2010

PREPARED FOR:

ELECTRIX INC  
NEW HAVEN, CT

TESTED IN ACCORDANCE WITH IES PROCEDURES.

LIGHTING SCIENCES, INC.  
7826 E. EVANS RD.  
SCOTTSDALE, AZ, USA 85260

CERTIFIED TEST REPORT No. 27322

ELECTRIX - INDIRECT COVE LUNINAIRE, CAT# FX 54UE52  
WITH SPECULAR HAMMERTONE REFLECTOR AND WHITE PAINTED REFLECTOR  
TWO GE 54 WATT T5 LAMP, CAT# F54W-T5/841/ECO. LUMEN RATING = 4450 LMS.  
ONE LUTRON EC5T554JUNV2 BALLAST OPERATING AT 120 VAC AND 126 WATTS

BEAM SIDE  
INTENSITY (CANDLEPOWER) DATA

ANGLE	PLANE						OUTPUT LUMENS
	ALONG	67.5	45	22.5	ACROSS	AVERAGE	
0	15	15	15	15	15	15	
5	26	23	24	26	24	24	1
10	27	25	33	43	41	34	
15	28	26	36	41	40	34	5
20	28	26	32	40	40	33	
25	28	26	35	42	44	35	8
30	28	27	40	44	47	37	
35	28	27	42	46	51	39	12
40	27	27	42	47	56	39	
45	25	26	40	50	62	40	15
50	24	26	37	51	67	40	
55	22	25	34	53	71	39	21
60	20	35	57	110	170	74	
65	17	62	118	285	401	168	88
70	14	95	257	517	679	304	
75	12	127	439	758	946	451	228
80	9	179	560	788	939	500	
85	7	278	533	770	942	514	291
90	7	322	670	964	1172	636	
95	45	520	922	1260	1508	869	478
100	116	769	1244	1619	1902	1160	
105	197	1001	1575	2013	2342	1464	769
110	279	1176	1874	2379	2749	1736	
115	361	1292	2115	2688	3091	1955	963
120	441	1373	2271	2930	3368	2120	
125	518	1436	2343	3046	3512	2210	986
130	596	1486	2359	3086	3567	2253	
135	669	1507	2318	3013	3479	2228	858
140	735	1494	2237	2840	3259	2142	
145	796	1457	2128	2640	2995	2030	639
150	849	1412	2000	2451	2754	1916	
155	894	1354	1842	2220	2472	1775	412
160	930	1286	1659	1969	2169	1616	
165	957	1209	1472	1685	1828	1440	207
170	978	1131	1283	1402	1484	1262	
175	990	1056	1119	1165	1192	1108	56
180	976	976	976	976	976	976	

LIGHTING SCIENCES, INC.  
 7826 E. EVANS RD.  
 SCOTTSDALE, AZ, USA 85260

CERTIFIED TEST REPORT No. 27322

ELECTRIX - INDIRECT COVE LUNINAIRE, CAT# FX 54UE52  
 WITH SPECULAR HAMMERTONE REFLECTOR AND WHITE PAINTED REFLECTOR  
 TWO GE 54 WATT T5 LAMP, CAT# F54W-T5/841/ECO. LUMEN RATING = 4450 LMS.  
 ONE LUTRON EC5T554JUNV2 BALLAST OPERATING AT 120 VAC AND 126 WATTS

OPPOSITE SIDE TO BEAM  
 INTENSITY (CANDLEPOWER) DATA

ANGLE	PLANE						OUTPUT LUMENS
	ALONG	112.5	135	157.5	ACROSS	AVERAGE	
0	15	15	15	15	15	15	
5	26	26	24	20	11	22	1
10	27	28	30	28	22	28	
15	28	30	31	31	27	30	4
20	28	30	33	33	31	31	
25	28	30	32	31	31	31	7
30	28	29	29	27	27	28	
35	28	28	26	23	23	26	8
40	27	26	22	19	18	22	
45	25	24	18	15	14	19	7
50	24	20	14	11	10	15	
55	22	16	10	7	6	12	5
60	20	12	6	2	2	8	
65	17	8	2	0	0	5	3
70	14	5	0	0	0	3	
75	12	2	0	0	0	2	1
80	9	1	0	0	0	1	
85	7	2	1	0	0	2	1
90	7	6	3	1	0	3	
95	45	20	14	6	0	16	10
100	116	47	31	15	0	38	
105	197	87	52	26	0	66	36
110	279	161	74	38	3	104	
115	361	223	100	51	6	139	70
120	441	281	161	62	8	182	
125	518	349	238	113	33	244	111
130	596	428	313	212	130	329	
135	669	508	389	311	244	416	158
140	735	575	456	372	312	481	
145	796	643	526	435	371	547	171
150	849	708	603	513	451	618	
155	894	766	675	595	540	688	158
160	930	817	742	676	629	754	
165	957	863	803	751	712	813	114
170	978	900	853	816	787	863	
175	990	938	905	877	856	911	43
180	976	976	976	976	976	976	

LIGHTING SCIENCES, INC.  
 7826 E. EVANS RD.  
 SCOTTSDALE, AZ, USA 85260

CERTIFIED TEST REPORT No. 27322

ELECTRIX - INDIRECT COVE LUNINAIRE, CAT# FX 54UE52  
 WITH SPECULAR HAMMERTONE REFLECTOR AND WHITE PAINTED REFLECTOR  
 TWO GE 54 WATT T5 LAMP, CAT# F54W-T5/841/ECO. LUMEN RATING = 4450 LMS.  
 ONE LUTRON EC5T554JUNV2 BALLAST OPERATING AT 120 VAC AND 126 WATTS

COEFFICIENTS OF UTILIZATION

ZONAL CAVITY METHOD

EFFECTIVE FLOOR CAVITY REFLECTANCE = .20

CC WALL	90				80				70				50				30				10				0	
	70	50	30	10	70	50	30	10	70	50	30	10	50	30	10	50	30	10	50	30	10	50	30	10	0	
RCR	0	0.860	.860	.860	.86	0.760	.760	.760	.76	0.660	.660	.660	.66	0.480	.480	.48	0.310	.310	.31	0.150	.150	.15	0.08			
	1	0.770	.730	.690	.66	0.680	.640	.610	.58	0.590	.560	.530	.50	0.400	.380	.36	0.250	.240	.23	0.110	.110	.10	0.04			
	2	0.690	.620	.570	.52	0.610	.550	.500	.46	0.530	.480	.430	.40	0.340	.310	.28	0.210	.190	.18	0.090	.080	.07	0.02			
	3	0.630	.550	.480	.42	0.560	.480	.420	.38	0.480	.420	.370	.33	0.290	.260	.23	0.180	.160	.14	0.080	.070	.06	0.01			
	4	0.580	.480	.410	.35	0.510	.420	.360	.31	0.430	.370	.310	.27	0.260	.220	.20	0.160	.140	.12	0.070	.060	.05	0.01			
	5	0.530	.410	.350	.30	0.460	.370	.310	.26	0.400	.320	.270	.23	0.230	.190	.17	0.140	.120	.10	0.060	.050	.04	0.01			
	6	0.480	.380	.310	.25	0.420	.330	.270	.23	0.360	.290	.240	.20	0.200	.170	.14	0.130	.100	.09	0.050	.040	.03	0.00			
	7	0.440	.340	.270	.22	0.390	.300	.240	.19	0.340	.260	.210	.17	0.180	.150	.12	0.110	.090	.07	0.050	.040	.03	0.00			
	8	0.410	.300	.230	.19	0.360	.270	.210	.17	0.310	.230	.180	.15	0.160	.130	.11	0.100	.080	.07	0.040	.030	.03	0.00			
	9	0.380	.270	.210	.16	0.330	.240	.180	.15	0.290	.210	.160	.13	0.150	.120	.09	0.090	.070	.06	0.040	.030	.02	0.00			
	10	0.350	.250	.190	.15	0.310	.220	.170	.13	0.270	.190	.140	.11	0.140	.100	.08	0.090	.060	.05	0.040	.030	.02	0.00			

LUMINAIRE INPUT WATTS 126.0

LABORATORY RESULTS MAY NOT BE REPRESENTATIVE OF FIELD PERFORMANCE.  
 BALLAST AND FIELD FACTORS HAVE NOT BEEN APPLIED.

TEST DISTANCE EXCEEDS FIVE TIMES THE GREATEST  
 LUMINOUS OPENING OF LUMINAIRE.